



# Bonding Adhesive Product Data

## RubberBond Bonding Adhesive

RubberBond high-strength, solvent-based bonding adhesive that allows fast, effective bonding of RubberBond FleeceBack membrane to most building materials.

The bonding adhesive is generally used at angle changes, steep slope and vertical details on the roof, if required the whole roof area can be bonded with RubberBond Bonding Adhesive.

### Features and Benefits

- Coverage rates of 1.6-2.4 m<sup>2</sup>/litre
- Fast Curing
- Available in 2.5 & 5 Litre cans
- Up to 12 m<sup>2</sup> coverage per 5 litre container

### Suitable Surfaces

RubberBond Bonding Adhesive is specially formulated for application with a spreader brush or medium nap roller. This highly versatile adhesive will bond RubberBond FleeceBack to a large variety of surfaces including brick, render, timber, metals, plastics and approved insulation.

Not to be used with expanded polystyrene.



### Surface Preparation

1. Surfaces should be clean, dry, frost free and free from dust, grease, loose material and other contaminants.
2. For timber and composite boards the surface must be sound and not be degraded.
3. Stir adhesive before vigorously before use.
4. Prolonged job site storage at temperatures in excess of 30°C may affect product shelf life.

**Exclusive British Isles Distributors for Carlisle-SynTec and RubberBond EPDM single ply roofing materials.**

Flex-R Ltd, Sandswood House, Hillbottom Road, Sands Industrial Estate, High Wycombe, Bucks, HP12 4HJ. Tel: +44 (0)1494 448792 Fax: +44 (0)1494 858433





# Bonding Adhesive Product Data

## Application

1. Stir before use, apply using a medium pile roller or spreader brush to achieve a thin even coating of adhesive to both surfaces to be mated together. A larger quantity of adhesive may be necessary for open texture and rough surfaces.

2. Allow the solvent content to evaporate before bonding the materials. The time for this evaporation will depend on the temperature and humidity. On absorbent or permeable materials such as timber, bonding may be possible within a matter of 2-3 minutes of application; on non-absorbent or non-permeable materials such as metal a minimum of 15 minutes should elapse before the surfaces are bonded.

3. The effective open time range will be vary dependant on temperature in the summer months. Care should be taken to ensure the adhesive is fully dry before surfaces are mated together.

4. Carefully align the surface to be mated, the roof sheet should be pressed onto the surface to be mated. Apply pressure to the surfaces with a roller to ensure full adhesion, smooth membrane and remove any trapped air.

5. Trimming of membrane may be commenced immediately.

RubberBond Bonding Adhesive	
Base	Polychloroprene Rubber / Phenolic Resin
Viscosity	Approx. 6000 - 6500 Cps (at make)
Specific Gravity	Approx. 0.8
Colour	Golden brown
Tack Life	2 - 20 mins
Flash Point	-22 °C
Coverage	Approx. 1.6 – 2.4 m <sup>2</sup> /ltr
Shelf Life	18 months between 5°C and 25°C

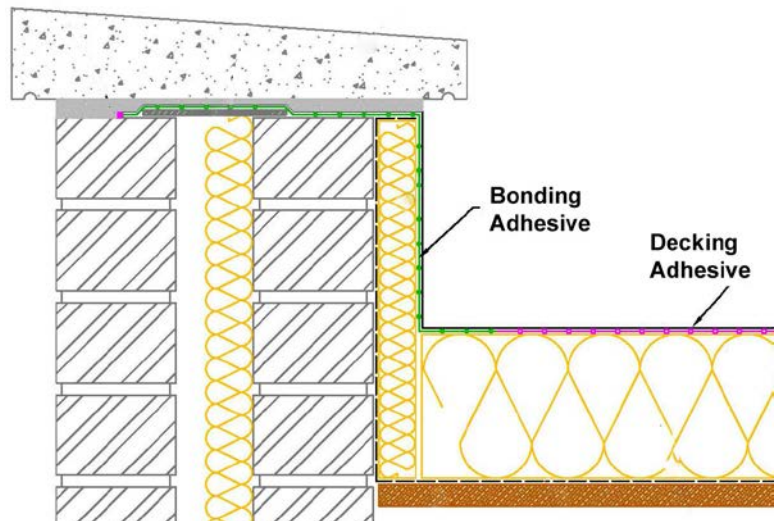

Before using this product please ensure that you have been supplied with and have read carefully the following information:

1. The product labels
2. RubberBond Bonding Adhesive Material Safety Data Sheet

**Exclusive British Isles Distributors for Carlisle-SynTec and RubberBond EPDM single ply roofing materials.**

Flex-R Ltd, Sandswood House, Hillbottom Road, Sands Industrial Estate, High Wycombe, Bucks, HP12 4HJ. Tel: +44 (0)1494 448792 Fax: +44 (0)1494 858433

